



Grooved Swing Check Valve Fig.306

General Description

Rapidrop Fig.306 is a rubber faced, grooved swing type check valve that allows water flow in one direction only. A hinged clapper remains open with water flowing in one direction, and automatically closes, with the help of an incorporated spring, when flow stops preventing backflow. Rapidrop Fig.306 grooved swing check valve is suitable for installation in both horizontal and vertical position (with the flow upwards).

Connections

Groove to AWWA C606

Maximum Working Pressure

25.2 bar (365 psi)

Coating

Fusion Bonded Epoxy Coating In accordance with ANSI/AWWA C550

Approvals

FM Approved

UL Listed

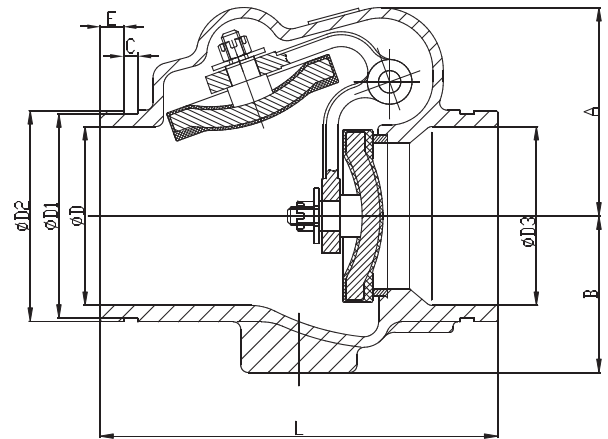

Dimensions

| Sizes | | Dimensions (mm) | | | | | | | | | Weight kg |
|-------|--------|-----------------|-----|-------|-------|-----|-----|-------|-------|-----|--------------|
| mm | Inch | A | B | C | E | L | ØD | ØD1 | ØD2 | ØD3 | |
| DN50 | 2" | 85 | 65 | 7.93 | 15.88 | 169 | 52 | 57 | 60.3 | 52 | 4 |
| DN65 | 2 1/2" | 94 | 68 | 7.93 | 15.88 | 203 | 62 | 69.1 | 73.0 | 62 | 5 |
| DN65 | 2 1/2" | 94 | 68 | 7.93 | 15.88 | 203 | 62 | 72.2 | 76.1 | 62 | 5 |
| DN80 | 3" | 109 | 80 | 7.93 | 15.88 | 213 | 76 | 84.9 | 88.9 | 76 | 6 |
| DN100 | 4" | 122 | 92 | 9.53 | 15.88 | 245 | 103 | 110 | 114.3 | 100 | 10 |
| DN125 | 5" | 140 | 105 | 9.53 | 15.88 | 267 | 120 | 137 | 139.7 | 120 | |
| DN125 | 5" | 140 | 105 | 9.53 | 15.88 | 267 | 120 | 135.4 | 141.3 | 120 | |
| DN150 | 6" | 158 | 120 | 9.53 | 15.88 | 292 | 148 | 164 | 165.1 | 147 | 20 |
| DN150 | 6" | 158 | 120 | 9.53 | 15.88 | 292 | 148 | 160.8 | 168.3 | 147 | 20 |
| DN200 | 8" | 270 | 150 | 11.13 | 19.05 | 356 | 198 | 214.4 | 219.1 | 196 | 28 |
| DN250 | 10" | 303 | 170 | 12.7 | 19.05 | 432 | 248 | 268.3 | 273.0 | 248 | |
| DN300 | 12" | 373 | 200 | 12.7 | 19.05 | 495 | 292 | 318.3 | 323.9 | 292 | |

Grooved Swing Check Valve Fig.306

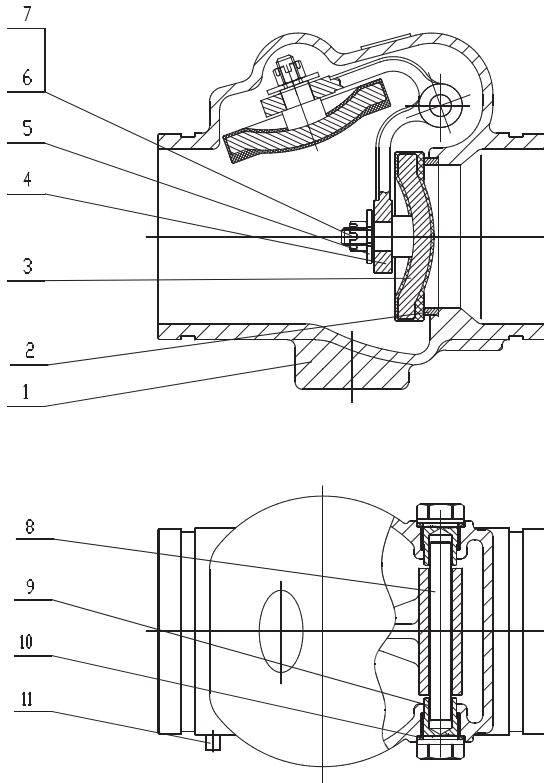

Material Specification

| Part No | Part Description | Material |
|---------|------------------------|------------------------------------|
| 1 | Body | Ductile Iron |
| 2 | Seat | Brass |
| 3 | Disc | Steel + Stainless Steel 304 + EPDM |
| 4 | Swing arm | Stainless Steel 304 |
| 5 | Washer | Stainless Steel 304 |
| 6 | Hexagon Slot Thin Nut | Stainless Steel 304 |
| 7 | Split Pin | Stainless Steel 304 |
| 8 | Shaft | Stainless Steel 304 |
| 9 | Shaft Hole Plug | Stainless Steel 304 |
| 10 | Plug Gasket | EPDM |
| 11 | Plug | Stainless Steel 304 |
| 12 | Eyebolt (8" and above) | Stainless Steel 304 |

Installation

The valve must be installed with the direction arrow on the body coincident with the direction of the flow in the pipeline. Rapidrop grooved swing check valve can be installed horizontally or vertically. For vertical pipework the flow direction should be upwards only. Large valves are provided with lifting eye bolt, which should be used to manoeuvre the valve.

Pressure Loss Graph

