



Standard Flexible Coupling Model 1N



Material Specification

- Body - Ductile Iron, ASTM A536
- Bolts and nuts - Mild steel Zinc Plated, ASTM A183, ISO898

Gasket Specification

- EPDM, ASTM D2000
- Temperature range -34°C to +110°C (-30°C to +230°F).
Recommended for hot water service within specified temperature range plus a variety of diluted acids, oil free air and many chemical services. Not recommended for petroleum service.

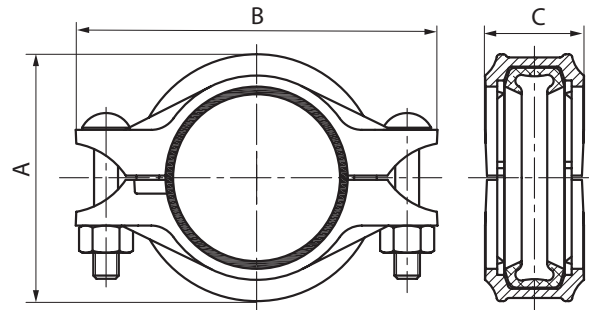

Finish

- Red painted (RAL 3000)
- Galvanised

Model Number (Red Painted)	Model Number (Galvanised)	Nominal Size mm/in	Pipe O.D mm/in	Max. Working Pressure bar/psi				Max End Load kN/Lbs	Pipe End Separation mm/in	Dimensions			Bolt Size No.-Size mm
				UL	FM	VdS	CNBOP			A mm/in	B mm/in	C mm/in	
RD1N033	RD1N033G	25 1	33.7 1.327	-	20.7 300	16 232	20 290	3.0/680	0-1.6 0-0.06	55 2.16	92 3.62	42 1.65	2 - 3/8 x 55 2 - M10X57
RD1N042	RD1N042G	32 1¼	42.4 1.669	20.7 300	20.7 300	16 232	20 290	2.9/650	0-1.6 0-0.06	65 2.56	104 4.14	44 1.74	2 - 3/8 x 55 2 - M10X57
RD1N048	RD1N048G	40 1½	48.3 1.900	20.7 300	20.7 300	16 232	20 290	3.8/850	0-3.2 0-0.13	70 2.75	110 4.33	44 1.74	2 - 3/8 x 55 2 - M10X57
RD1N060	RD1N060G	50 2	60.3 2.375	20.7 300	20.7 300	16 232	20 290	5.9/1330	0-3.2 0-0.13	83 3.27	125 4.92	44 1.74	2 - 3/8 x 55 2 - M10X57
RD1N076	RD1N076G	65 2½	76.1 3.000	20.7 300	20.7 300	16 232	20 290	9.4/2120	0-3.2 0-0.13	100 3.94	145 5.71	45 1.78	2 - 3/8 x 55 2 - M10X57
RD1N089	RD1N089G	80 3	88.9 3.500	20.7 300	20.7 300	16 232	20 290	12.8/2885	0-3.2 0-0.13	115 4.53	160 6.30	45 1.78	2 - 1/2 x 70 2 - M12X70
RD1N114	RD1N114G	100 4	114.3 4.500	20.7 300	20.7 300	16 232	20 290	21.2/4770	0-3.2 0-0.13	145 5.71	198 7.80	50 1.97	2 - 1/2 x 70 2 - M12X70
RD1N139	RD1N139G	125 5	139.7 5.500	20.7 300	20.7 300	16 232	20 290	47.5/10680	0-3.2 0-0.13	169 6.65	230 9.06	52 2.05	2 - 5/8 x 85 2 - M16X85
RD1N168	RD1N168G	150 6	168.3 6.625	20.7 300	20.7 300	16 232	20 290	46.0/10340	0-3.2 0-0.13	200 7.87	265 10.43	52 2.05	2 - 5/8 x 85 2 - M16X85
RD1N219	RD1N219G	200 8	219.1 8.625	31.0 450	20.7 300	16 232	20 290	116.9/26280	0-3.2 0-0.13	258 10.24	350 13.78	60 2.37	2 - 3/4 x 115 2 - M20X115
RD1N273	RD1N273G	250 10	273.0 10.750	15.5 225	20.7 300	16 232	20 290	121.0/27210	0-3.2 0-0.13	337 13.27	406 16.00	65 2.56	2 - 7/8 x 125 2 - M22X140
RD1N323	RD1N323G	300 12	323.9 12.750	15.5 225	20.7 300	-	20 290	170.3/38280	0-3.2 0-0.13	378 14.96	465 18.31	65 2.56	2 - 7/8 x 125 2 - M22X140



Standard Flexible Coupling Model 1N



1. Pipe Preparation

Check pipe end for proper groove dimensions and to assure that pipe end is free of indentations and projections that would prevent proper sealing.



2. Lubricate Gasket

Check gasket to be sure it's compatible for the intended service. Apply thin lubricant to the outside and sealing lips of the gasket.



3. Gasket Installation

Slip the gasket over one pipe, making sure the gasket lip does not over-hang the pipe end.



4. Alignment

After aligning two pipe ends together, pull the gasket into position, centering between the grooves on each pipe. The gasket should not extend into the groove on either pipe.



5. Housing Installation

Remove one bolt&nut and loosen the other nut. Place one housing over the gasket, making sure the housing keys fit into the pipe grooves. Swing the other housing over the gasket and into the grooves on both pipes. Re-insert the bolt and connect two housings.



6. Tighten Nuts

Firstly hand tighten nuts and make sure oval neck bolt completely fits into bolt hole. Then securely tighten nuts alternatively and equally to the specified bolt torque by using spanner.



7. Assembly Completed
Flexible Coupling

For Flexible Coupling, two housings should be iron to iron connected. Gaskets can't be seen visually.

Caution

Proper torquing of bolts is required to obtain specified performance.

- Over torquing the bolts may result in damage to the bolt and / or casting which could result in pipe joint separation.
- Under torquing the bolts may result in lower pressure retention capabilities, lower bend load capabilities, joint leakage and pipe joint separation. Pipe joint separation may result in significant property damage and serious injury.

Specified Bolt Torque ANSI BOLTS

Bolt Size Inch	Specified Bolt Torque	
	Lbs-Ft.	N.m
3/8	30-45	40-60
1/2	80-100	110-135
5/8	100-130	135-175
3/4	130-180	175-245
7/8	180-240	245-325