



Threaded Monitored Butterfly Valve - Prewired

Product Description

Rapidrop Threaded Butterfly Valve is a rotary type valve with visual indication of whether the valve is in fully open position or not.

Butterfly valves are commonly used in fire protection systems as system control valves, zone valves. These valves have been designed with minimum flow restriction and pressure loss when in fully open position. To reduce the risk of a water hammer Rapidrop Butterfly Valves are provided with a slow close hand wheel operation gearbox.

Features

- Lockable handwheel fitted with key alike padlock
- Double tamper switch
- Pre-wired junction box

Approvals

FM Approved
UL Listed

Working Pressure

Max. Working Pressure 20.7 bar (300 psi)

Material Specification

Bronze ASTM 584 C83600 Body
304 Stainless steel disc
VITON / EPDM Seat

Connections

NPT threads in accordance with ANSI/ASME B1.20.1

Switch Specification

10A @ 115V AC, 0.5A @ 28V DC

Wiring Diagram

Schematic of switches with the valve in the fully open position

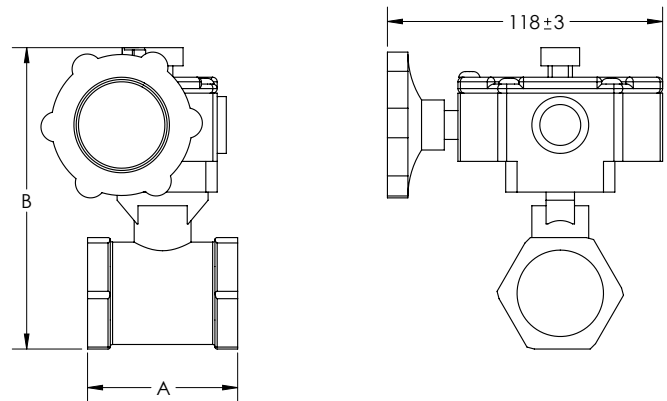
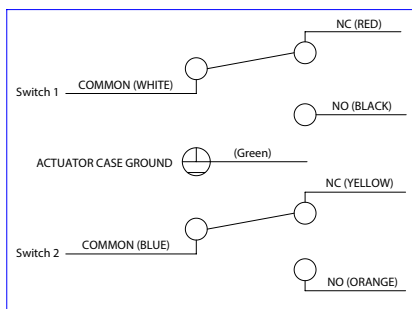

Dimensions

Size		Dimensions (mm)		Ordering Codes
mm	inch	A	B	
DN25	1"	54	125	RD2811A025PWL
DN32	1 1/4"	67	130	RD2811A032PWL
DN40	1 1/2"	73	142	RD2811A040PWL
DN50	2"	83	156	RD2811A050PWL